

MIXING MANIFOLD KIT 629097836 - 548000142

This kit provides instructions for replacement of the product mixing/infusion manifold.

1.0 Mixing - Infusion Manifold

- 1) In the cabinet rear, disconnect the air/water supply lines and the wiring connector.
- 2) Pull the mixing-dispensing assembly release latch forward, then lift the assembly out of the cabinet and place it on a bench or countertop.
- 3) On the underside of the assembly baseplate, remove the screws securing the mixing-infusion manifolds (Fig. 1).

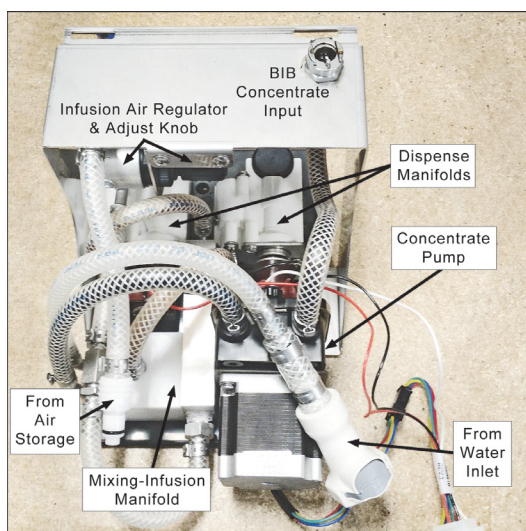

Figure 1 - Mixing-Dispensing Assembly

- 4) Use tape and a marker to label the five hoses.
- 5) Loosen the C-plate retainer screws where the four hoses connect to the manifold (Fig. 2).

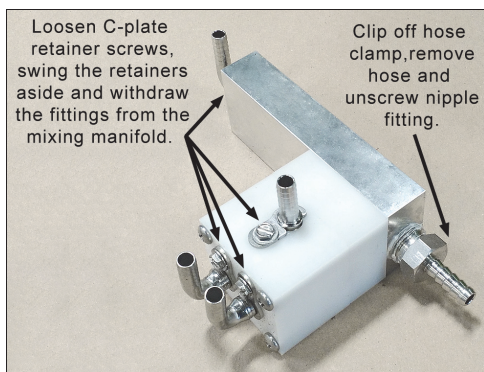

Figure 2 - Mixing Manifold Hose Fittings Removal

- 6) Move a C-plate retainer aside and rotate the hose fitting back and forth while withdrawing it from the manifold. Remove the four fittings. Check/replace their o-rings as needed.
- 7) Carefully remove the threaded, hose-nipple fitting from the infuser manifold by first removing the hose clamp using side cutters or the recommended Oetiker HIP 2800 Es crimping/cutting tool (Fig. 3). Cut the clamp open.

CAUTION!

Be careful to avoid damaging the tubing when removing the hose clamp.

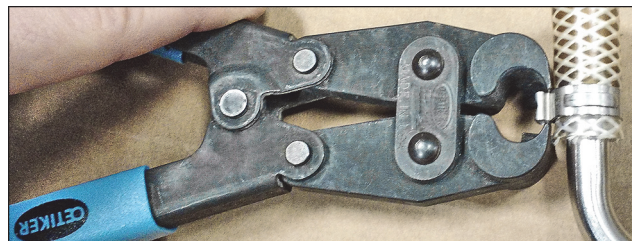

Figure 6-5 - Hose Clamp Removal (Oetiker Tool)

- 8) Remove the hose and unscrew the threaded, hose-nipple fitting. Clean off the Teflon tape and apply new tape (or use an NSFG1 pipe-sealing dope, such as T Plus 2 by Rector Seal).
- 9) Remove the mixing-infusion manifold and place the new one in the mixing-dispensing assembly.
- 10) Reinstall the hoses in reverse order. When tightening the threaded, hose-nipple fitting in the infuser manifold, tighten it finger tight and then rotate it 2 to 3 turns to prevent leakage. Use the Oetiker crimping tool (or equivalent) to install the hose clamp on the hose-nipple fitting.
- 11) Secure the manifold assembly to the baseplate by reinstalling the underside screws.
- 12) Reinstall the mixing-dispensing assembly in the cabinet, operate the dispenser and check all the manifold hose connections for leaks.



MIXING MANIFOLD KIT 629097836 - 548000142